

Tunstall

Lifeline 400



Quick Installation Guide

How to Programme Lifeline 400

1. Connect the telephone

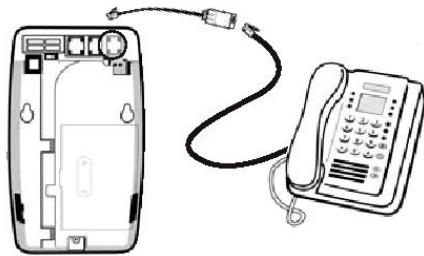

2. Place unit in programming mode

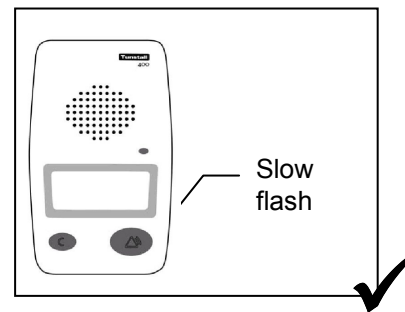
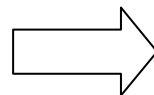
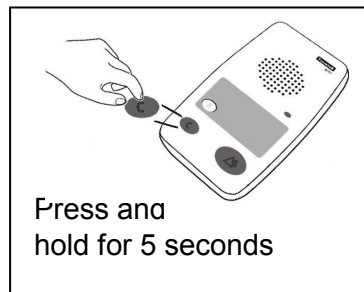

Emergency Telephone Numbers

* 0 0 * 2 2 3 *

To set the 1st Emergency number to dial a control centre with telephone number '223'

Note- to set personal recipient number- type # before the telephone number.

Unit Identification

* 0 2 * 3 0 0 *

To set the unit ID, type the number in parameter 02- a maximum of 12 digits can be used.

Assigning Radio Sensors

When in programming mode, press the cancel key for a further 3 seconds:-

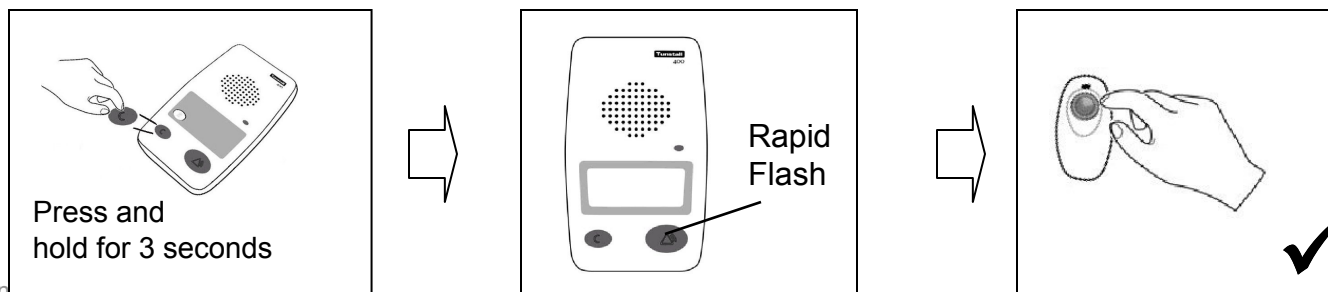

Removing a Sensor

Type the following quick code:-

3 0 0 0

Removing all Sensors

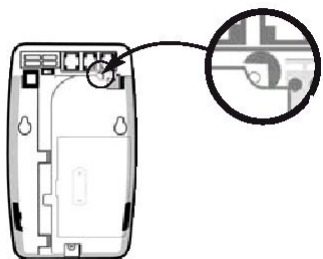

Press and hold down the volume button using a pen/pencil. A beep will be heard when all sensors have been removed.

Inactivity Monitoring

5 1 1 2

12 hour monitoring

5 1 2 4

24 hour monitoring.

Periodic Calls

* 1 2 * 3 0 1 0 *

No of days

24/36 hour setting- '10'= 24 hours & '11'= 36 hours.

* 1 2 * 3 0 1 1 *

Silent Calls

9 1 0 1

Silent call - alarm button flashing

9 1 0 8

Silent call- no alarm button flashing.

9 1 0 3

Restore back to default settings.

Exit Programming mode

Briefly press cancel key- alarm button will be fully lit.